

CONTEST 46



Contest



CONTE

TECHNICAL SP

length o.a.	14.14 m	46' - 5"
length w.l.	11.85 m	38' - 11"
beam	4.20 m	13' - 9"
draft standard keel	1.95 m	6' - 5"
draft winged keel	1.70 m	5' - 7"

ballast	6.200
displacement	15.400
fuel	600
fresh water	800
engine	74 kw/100



0123456789

EST 46

PECIFICATIONS

0 kg 13668 lbs
 0 kg 33960 lbs
 0 l 132 imp.gallons
 0 l 176 imp.gallons
 0 HP Volvo Penta

mastheight		
above waterline	21.25 m	69' - 9"
mainsail	46.62 m ²	502 sq.ft
genoa I	73.14 m ²	787 sq.ft
genoa II	60.80 m ²	654 sq.ft
spinnaker	184.00 m ²	1981 sq.ft

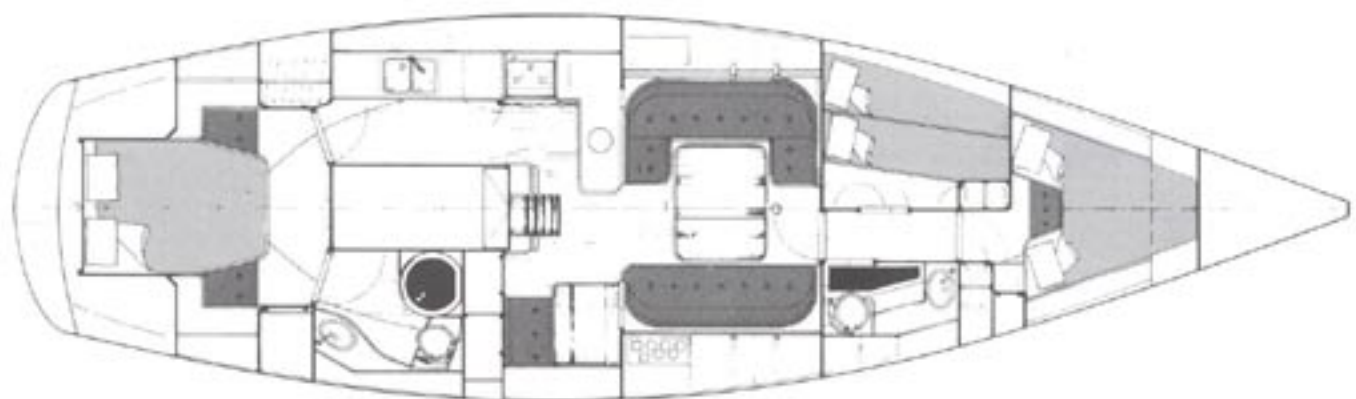
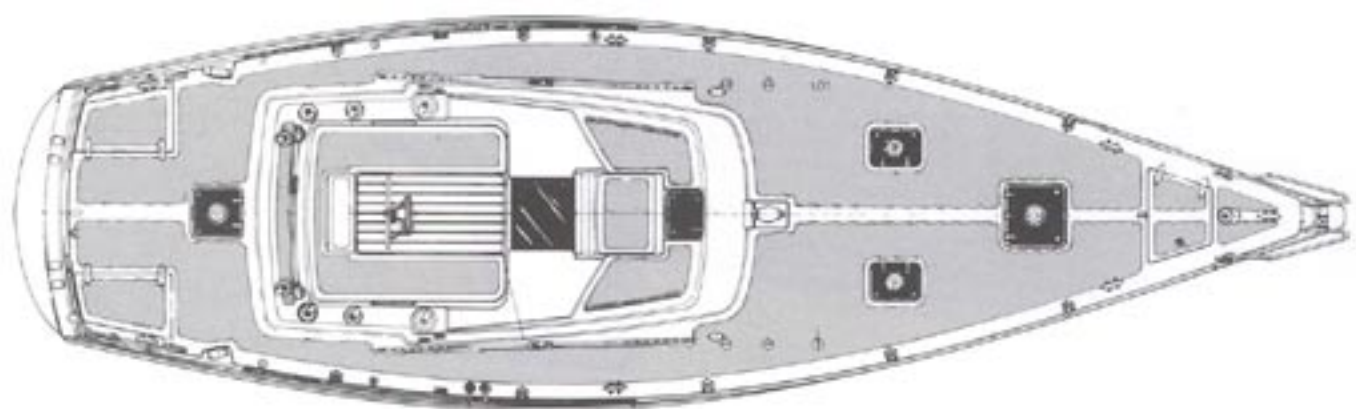
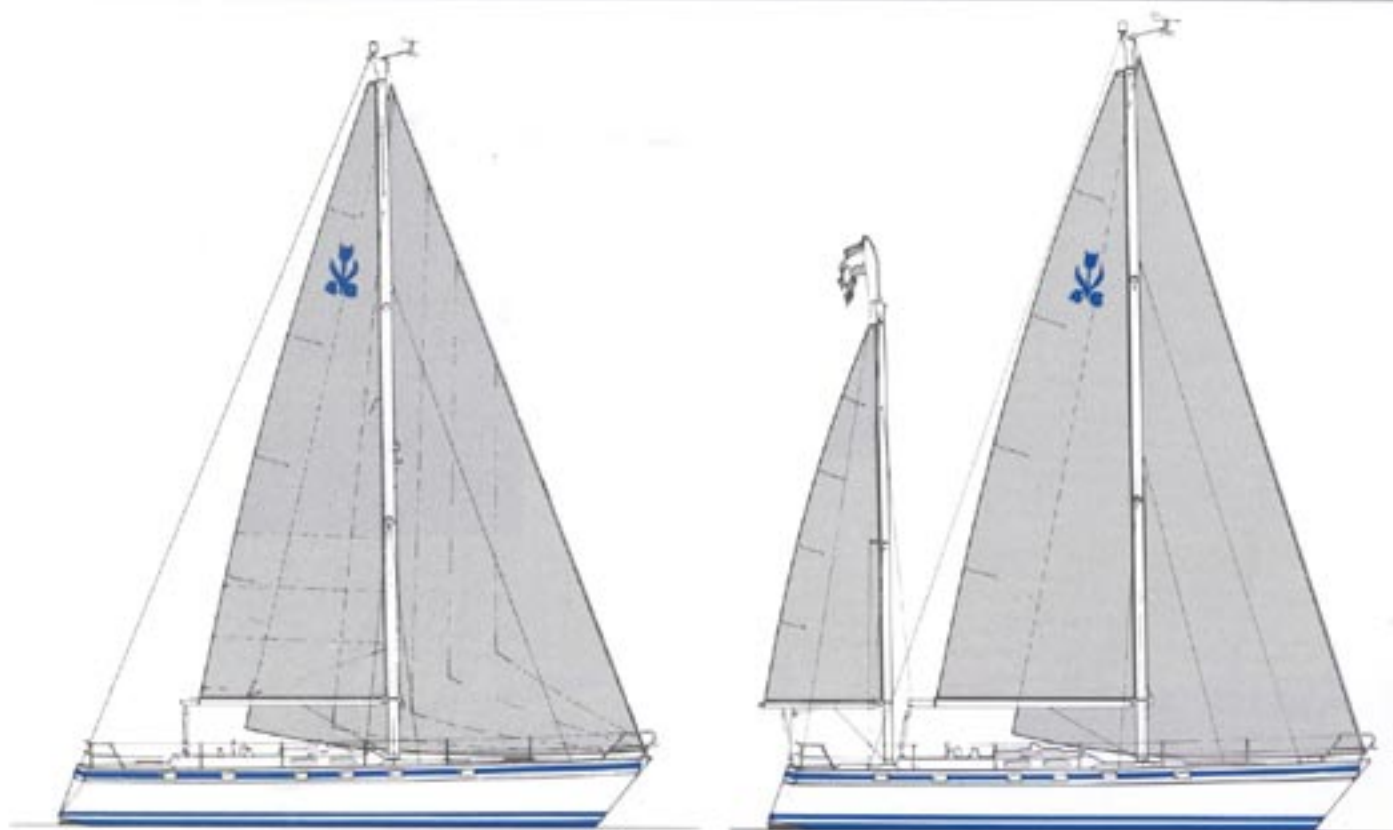

Conyplex b.v., Overleek 3, 1671 GD Medemblik, Holland, ☎ 02274-3644, Telefax 02274-3648

